

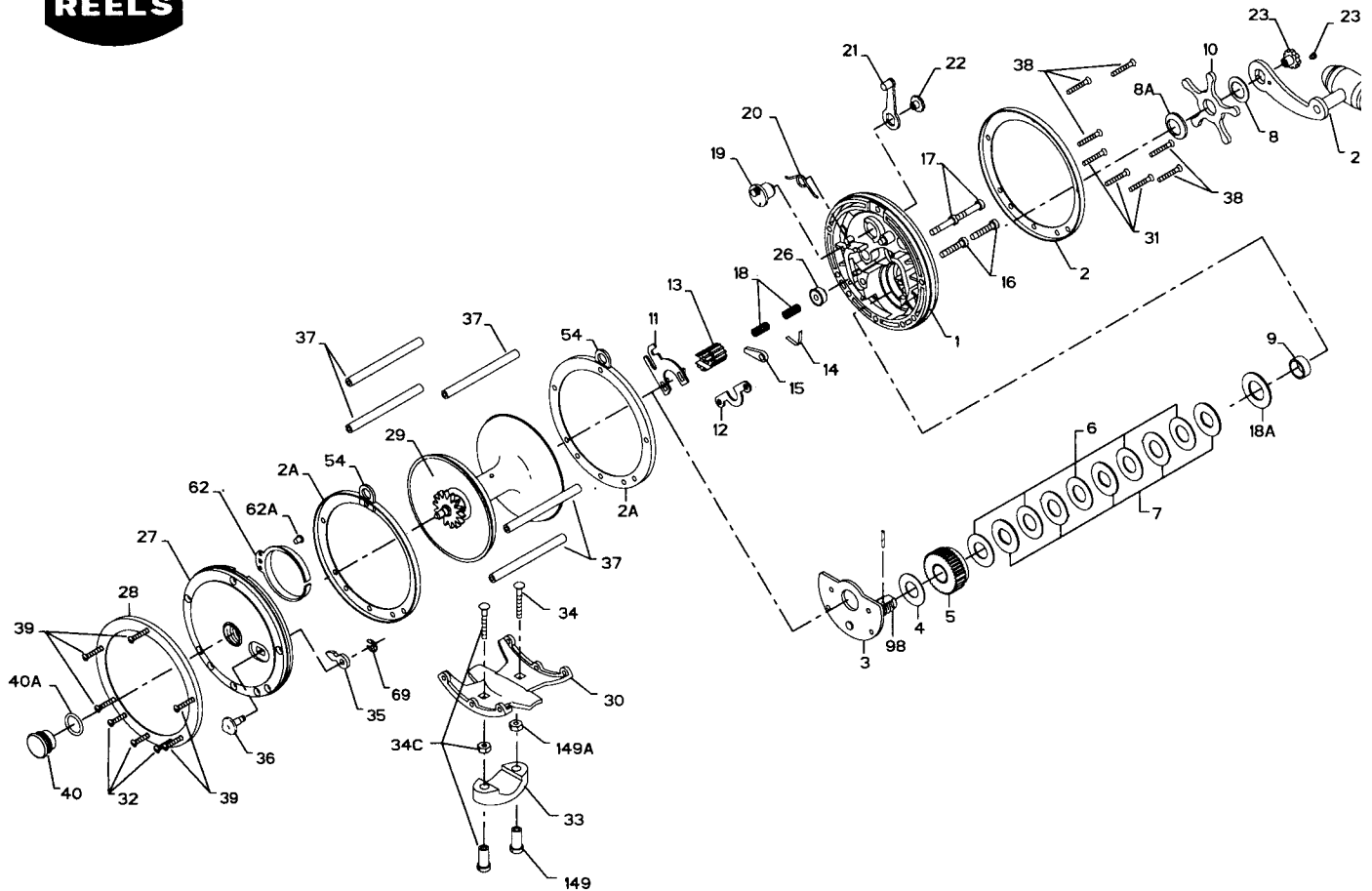

## PARTS AND PRICE LIST FOR MODELS 114 AND 114H



KEY No.	PART No.	Description	Price	KEY No.	PART No.	Description	Price
1	1-114	Right Side Plate	\$8.05	22	23-60	Eccentric Screw	\$1.70
<del>1</del>	1-114H	Right Side Plate	10.15	23	23-116	Handle Screw	3.10
2	2-114-O	Right Side Ring Outer	6.95	23A	110-60	Handle Lock Screw	.40
	2-114H-O	Right Side Ring Outer	6.95	24	24-114	Handle (114)	8.80
2A	2-114-I	Right Side Ring Inner	5.95		24-115	Handle (114H)	10.25
3	3-114	Bridge w/Sleeve	9.35	26	26-114	Bearing Right Side	2.65
	3-114H	Bridge w/Sleeve	9.70		26-116	Bearing Right Side (114H)	13.50
4	4-114	Fiber Washer (114)	.50	27	27-114	Left Side Plate	6.35
	4-115	Fiber Washer (114H)	.80		27N-114H	Left Side Plate	7.20
5	5-114	Main Gear (114)	6.35	28	2-114-1	Left Side Ring Inner	5.95
	5-115	Main Gear (114H)	7.15	29	29M-114	Spool	37.00
6	6-114	Drag Washer (114) (5 req.)	1.00		29M-114H	Spool	40.00
	6-115	Drag Washer (114H) (5 req.)	1.25	30	30-114	Stand	10.00
7	7C-114	Metal Drag Wshr Set (114)	3.50	31	31-11	R.S. Stand Screw (3 req.)	.50
	7C-115	Metal Drag Wshr Set (114H)	5.00	32	32-20	L.S. Stand Screw (3 req.)	.50
8	8-114	Tension Spring (Set of 2) (8 & 8A)	1.10	33	33-340	Rod Clamp	5.00
8A	8-115	Tension Spring	1.10		*33R-114	Ringed Rod Clamp (Optional)	9.95
9	9N-114	Spacing Sleeve (114)	3.10	34	34-45	Clamp Screw (2 req.)	.90
	9-114H	Spacing Sleeve (114H)	3.50	34C	34C-45	Rod Clamp Screw w/Nuts	2.25
10	10-114	Star Drag Wheel	4.40	35	35-114	Click Tongue	1.10
11	11-114	Eccentric Jack	2.65	36	36-114	Click Button	1.10
12	12-114	Pinion Yoke	1.80		36-114H	Click Button (114H)	1.10
13	13-114	Pinion (114)	5.10	37	37-114	Frame Post (114-114H)	1.95
	13-114H	Pinion (114H)	5.25	38	39-13	R.S. Post Screw (5 req.)	.50
14	14-114	Dog Spring	.45	39	39-12	L.S. Post Screw (5 req.)	.50
15	15-114	Dog (114)	1.10	40	40-114	L.S. Bearing (114)	2.80
	15-114H	Dog (114H)	1.10		**40-114HL	L.S. Bearing (114H)	12.95
16	16-114	Bridge Screw Lower (2 req.)	.50	40A	120-114H	L.S. Bearing O-Ring (114H)	.50
17	17-114	Bridge Screw Upper (2 req.)	.50	54	54-114	Harness Lug (2 req.)	1.70
18	18-114	Clutch Spring	.50	62	62-114	Click Spring	1.50
18A	18-114H	Spring Disc (114H)	.70	62A	63-209	Click Spring Screw	.80
19	19-114	Eccentric	2.45	69	69B-600	Retaining Ring	.90
20	20-114	Eccentric Spring	.80	98	98-114	Gear Sleeve	5.00
21	21-114	Eccentric Lever	2.25	149	149-45	Clamp Nut (2 req.)	.90
				149A	149-200	Hex Nut (2 req.)	.45

\*Not Shown

\*\*Owners of Older 114H reels must order 40-114H

41-114 .95